

J1- JANELA MAXIM-AR- 80x60

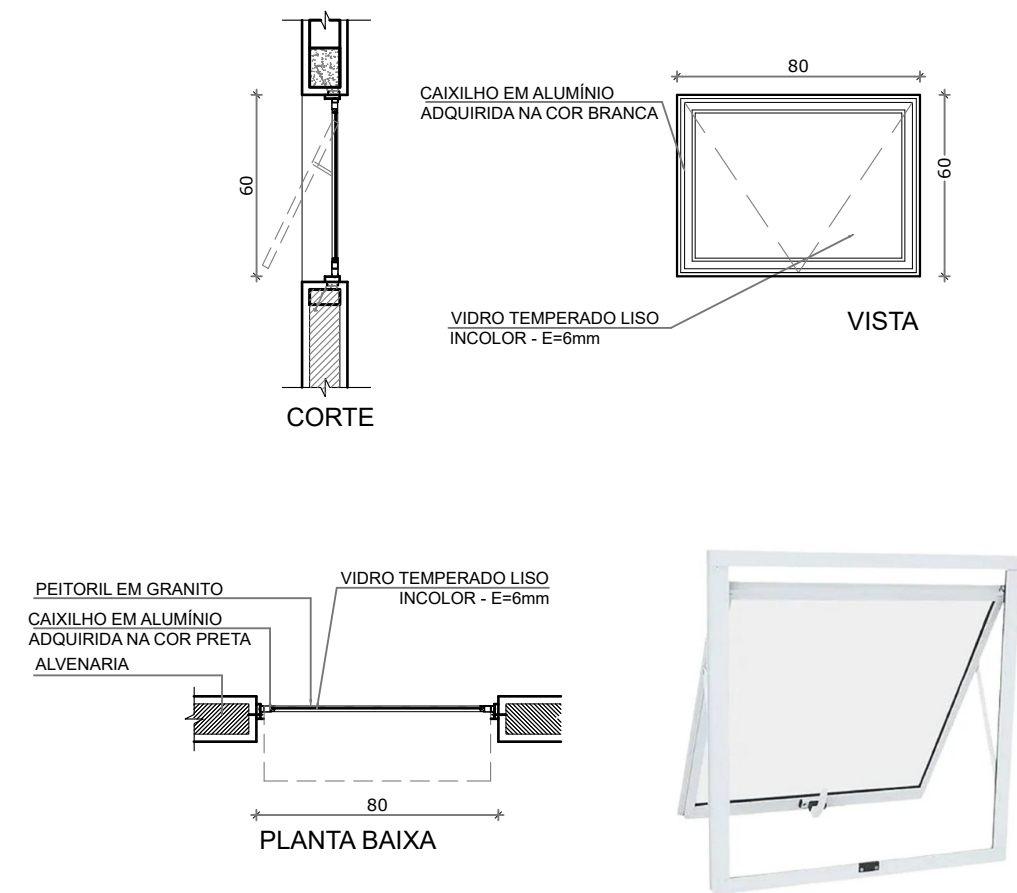

J2- JANELA DE CORRER - 140x100

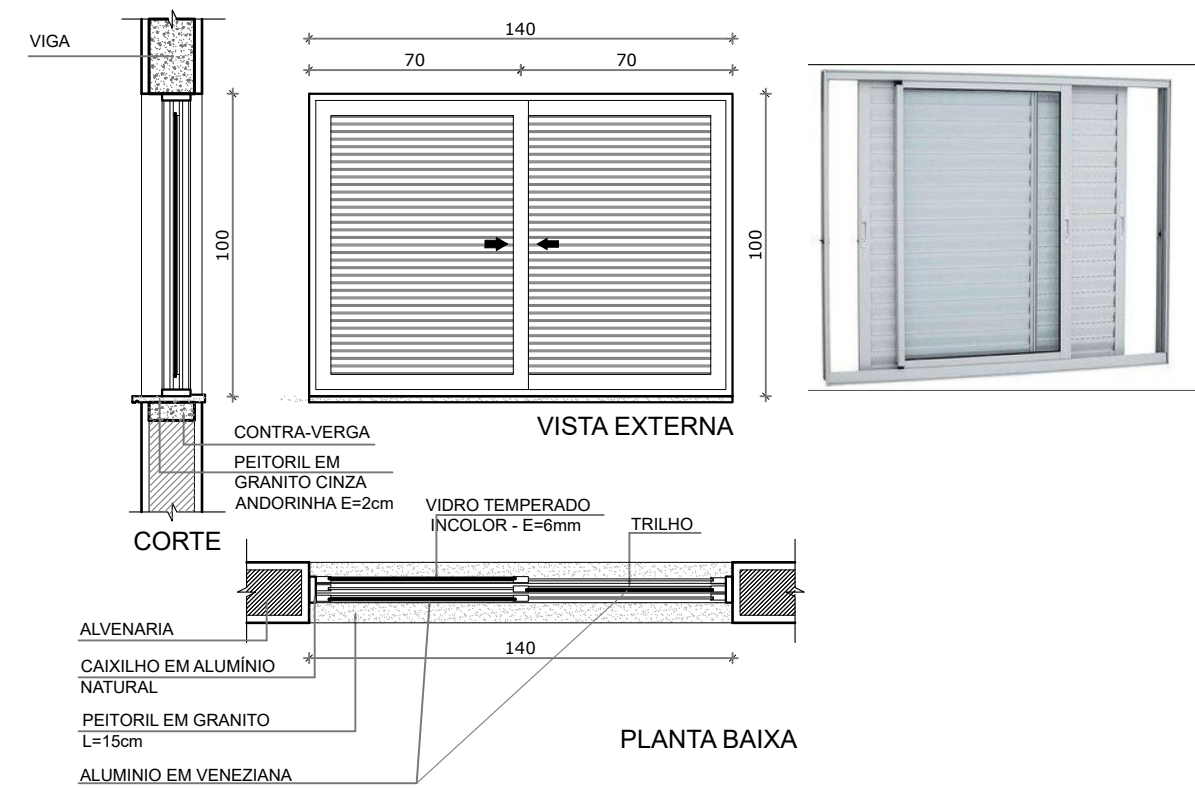

P1- PORTA DE MADEIRA COM VENEZIANA- 80x210

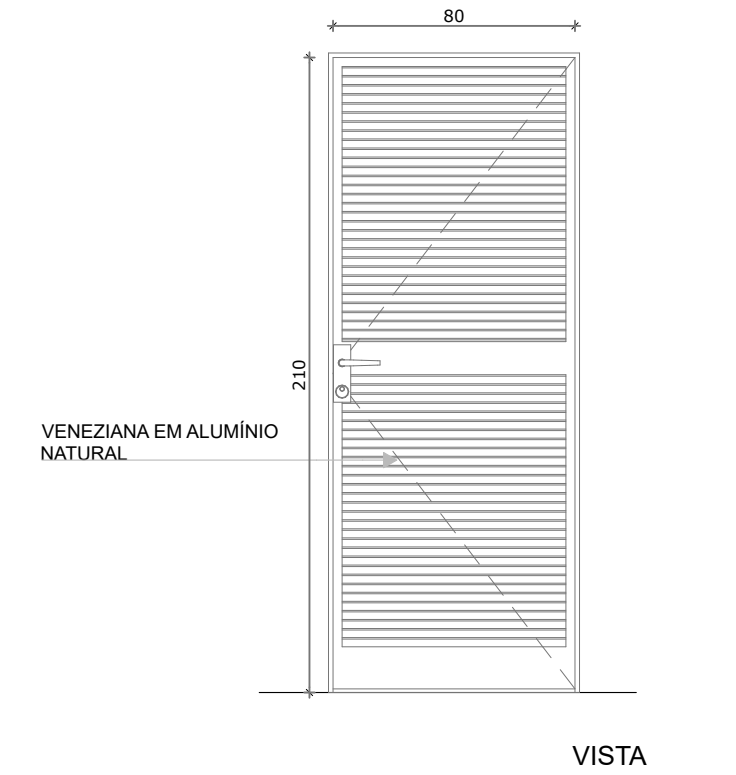

J4- JANELA DE CORRER- 120x100

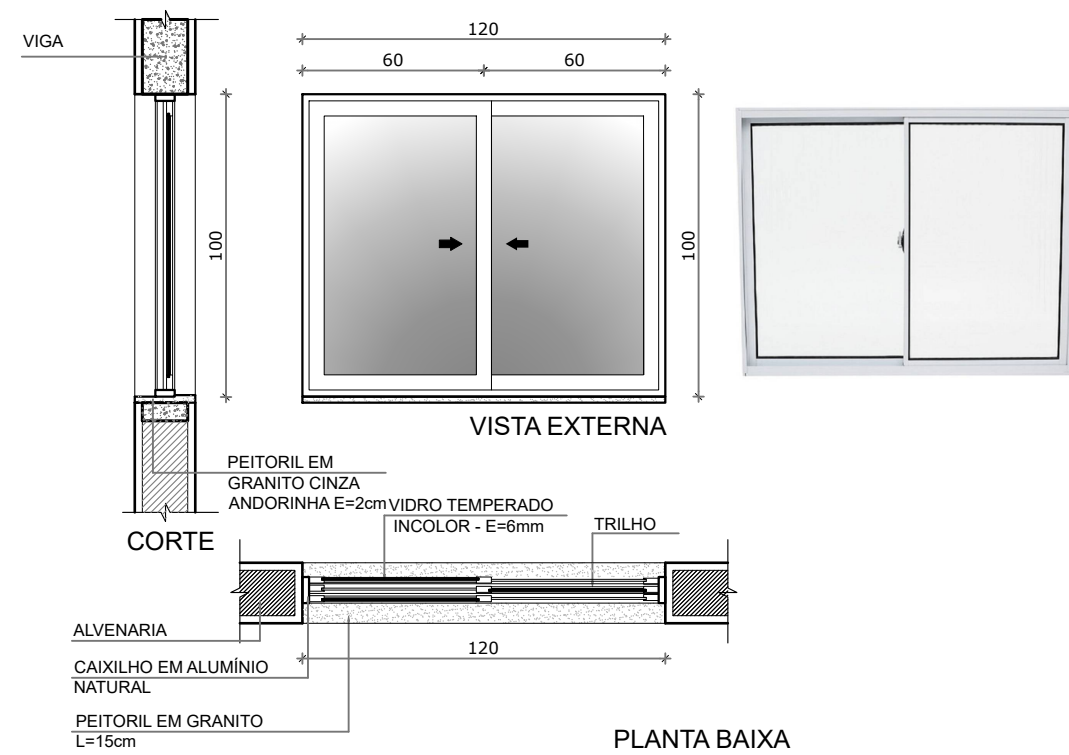

J3- JANELA DE CORRER- 140x100

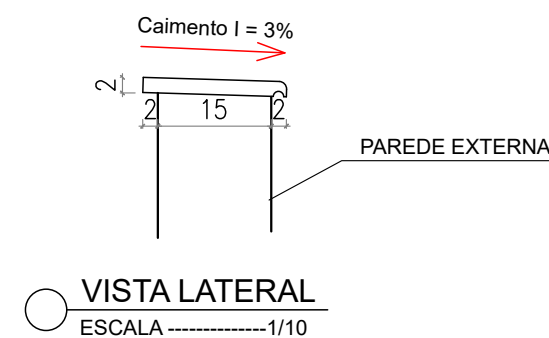
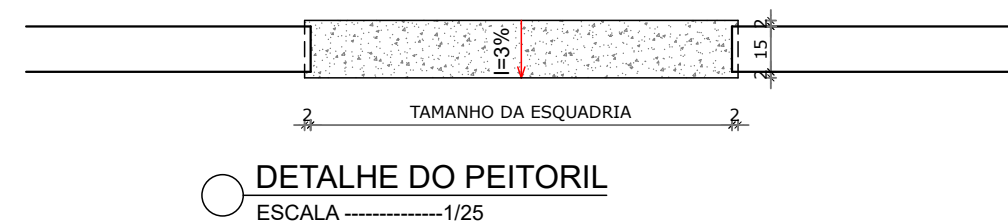
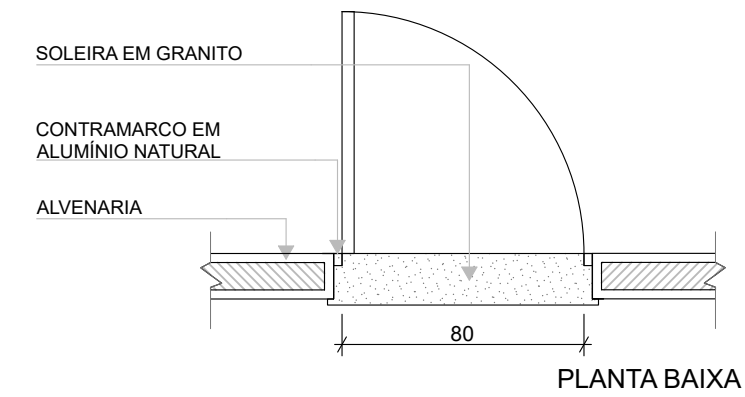
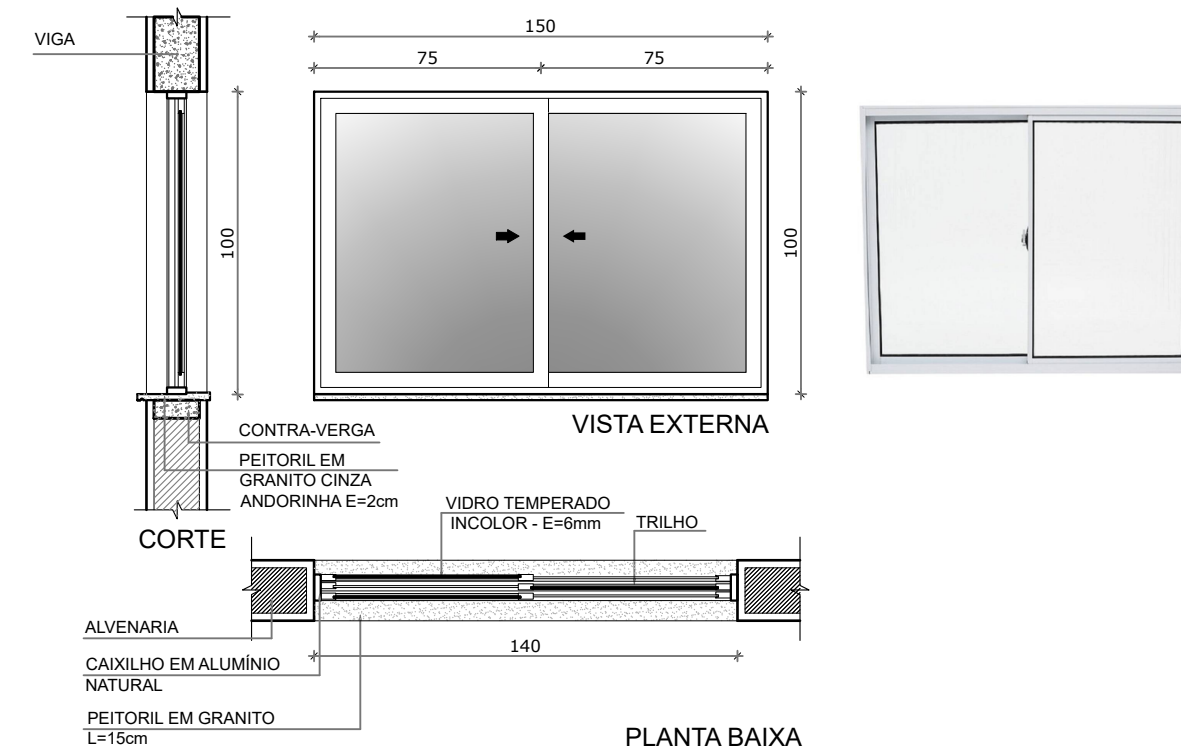



PLANEJAMENTO E ASSESSORIA DE
PROJETOS TÉCNICOS LTDA.

CLIENTE:

PREFEITURA MUNICIPAL DE BELÉM DO PIAUÍ- PI

PROJETO: CONSTRUÇÃO DE UNIDADES HABITACIONAIS NO MUNICIPIO DE
BELÉM DO PIAUÍ- PI

PROPOSTA Nº: Nº 040512/2025 - MINISTÉRIO DAS CIDADES/
P. M. DE BELÉM DO PIAUÍ (PI)

DESENHO:

DETALHE DAS ESQUADRIAS

PROJETISTA:

Danilo de Oliveira Soares
Engenheiro Civil
RN: 1915244544

LOCALIDADE:

ZONA URBANA

ESCALA:

1/50

DESENHO/CAD:

ANA VIANA

FORMATO:

A2

PRANCHA Nº:

ARQ.05/07

DADOS DE CAMPO:

TOPOGRAFO

DATA:

2025

REV.:

00

